



FIBER PALM ECONO TILE APPLICATION

Old Thatch removed from frame to rafters

Existing thatch cover was removed from frame to expose the wooden rafters and purlins.



Exterior grade shutter-ply board is installed on top of the exposed rafters and purlins, anchored onto the rafters with wood screws to ensure strength and create an entity between the rafters and the shutter-ply.





The shutter-ply is cut to size to ensure complete cover of the frame. We recommend that the shutter-ply sheet is installed with creating a roof overhang of 28 cm (280 mm).



Once the Shutter-ply has been installed the exterior of the shutter-ply is waterproofed with Fiber Dual component waterproofing.





Fiber Cloth is applied and waterproofed over the joints of the shutter-ply sheets to ensure a waterproof shell once completed.



To prepare for the application of the Fiber Palm Econo tiles a horizontal line is measured out and drawn onto the roof 28 cm (280 mm) from the shutter-ply board roof edge.





Once the first line has been measured and marked the second tile line can be measured and marked at the recommended 42 cm (420 mm) distance and the lines drawn horizontally on the roof. The third, fourth and (however many may be needed to the roof apex) lines can now also be measured and drawn in horizontally.

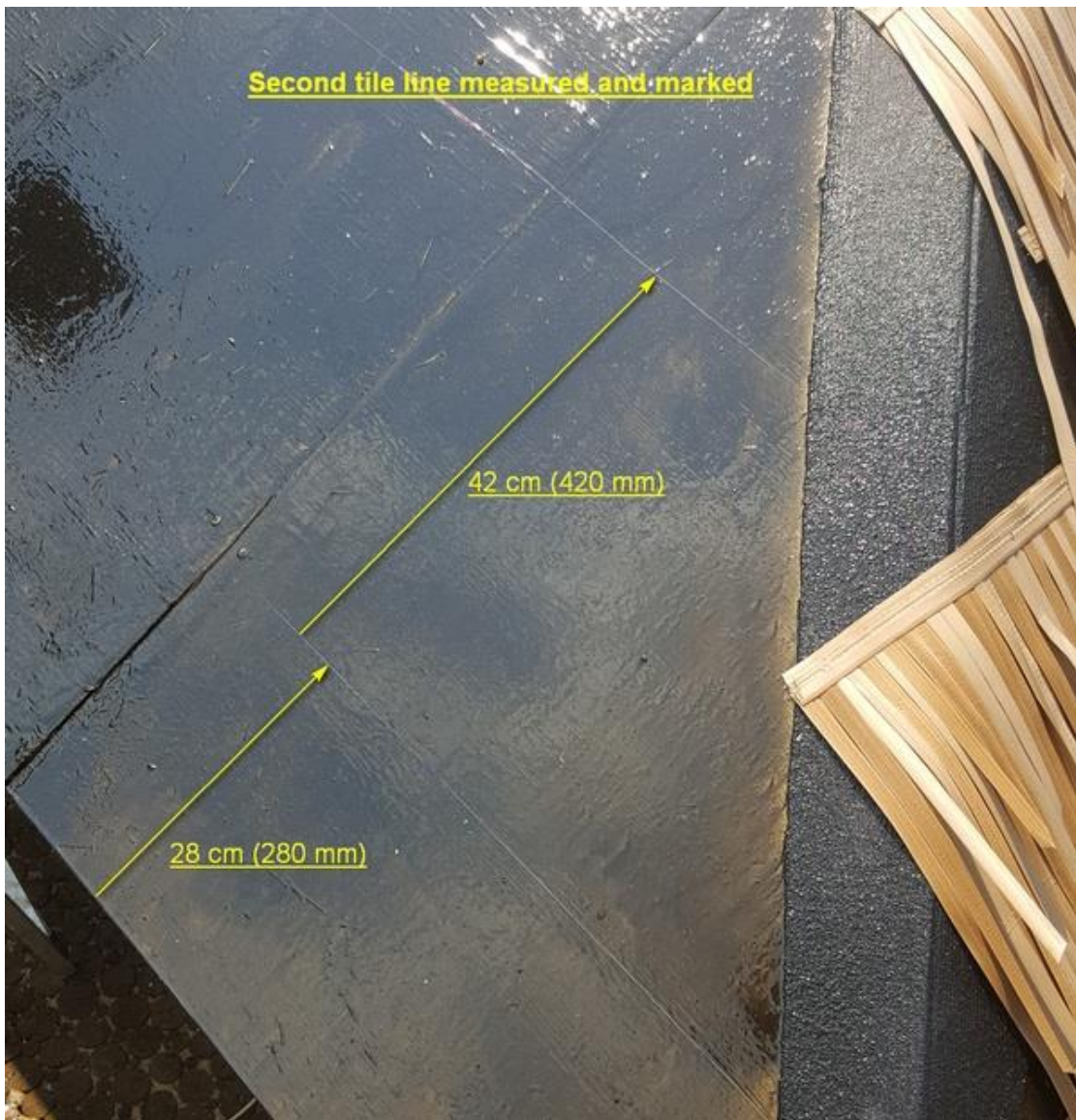

The First line of tiles on the roof edge can now be installed using the recommended Staple method. Pneumatic staple guns or spring loaded handheld staple guns can be used to do the application. The first line of tiles is installed with the bottom section of the Fiber Palm Econo tile protruding past the roof edge. The second bottom rib of the tile is stapled onto the roof edge with the upper bottom rib following the first horizontal line on the roof spaced 28 cm (280 mm) from the roof edge.



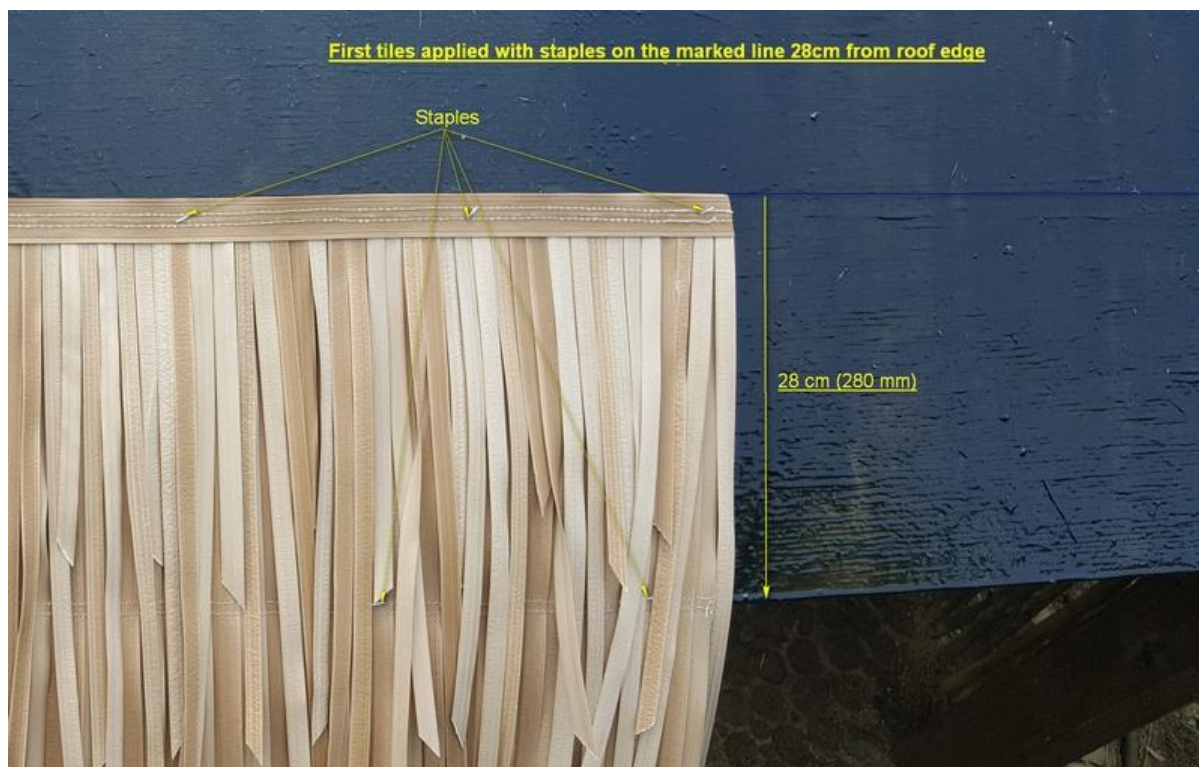

Once the first row of tiles has been applied and stapled down the second row of tiles can be applied in the recommended specified manner, spaced 42 cm (420 mm) above the first line of tiles to rib. The second line of tiles will overlay the first row of tiles as will every following row overlapping the previous row of tiles. The Fiber Palm Econo tile will have distinct even horizontal lines on the exterior of the roof once installed.





On the hips of the roofs the Tile rows are installed with the top corner of the tile being folded over the hip and then stapled into position as in the photo below. This is the proven and tested method ensuring the best coverage.



As can be seen in the photo below once the Fiber Palm Econo tile rows have been installed and folded over the hips as specified a diamond pattern of exposed waterproofing will be visible running along the hips on the roof. This will be covered by the installation of the Half Fiber Palm Econo tiles that will be applied over the hip section.





Contact & Postal Info:

Tel: +27 11 903 9204
Fax: +27 12 212 2341
Web: www.fiberroofing.com
E-mail: info@fiberroofing.com
P.O.Box 639, Alberton, 1450

FACTORY ADDRESS: INDUSTRIAL SITE - R59, KLIPRIVER, 1871 ,GAUTENG, SOUTH AFRICA

The half Fiber Palm Econo tiles are stapled into position over the hip with one half tile overlapping the previous tile in a staggered pattern all the way to the Apex of the roof. The Spacing in the overlapping pattern is ± 28 cm (280 mm) from one tile to the next.



The Hip tile installation is very similar to the traditional method used when installing natural palm leaves on roofs and covering the hips. T method is also synonymous to the clay tile hip cover installation method used on clay tile roofs.

To provide a neat finish to the roof thatch we recommend the use of a Fiber Palm Econo tile without the layered leaves that is fitted inverted under the roof overhang and stapled into position. The end result is an extremely neat finish.

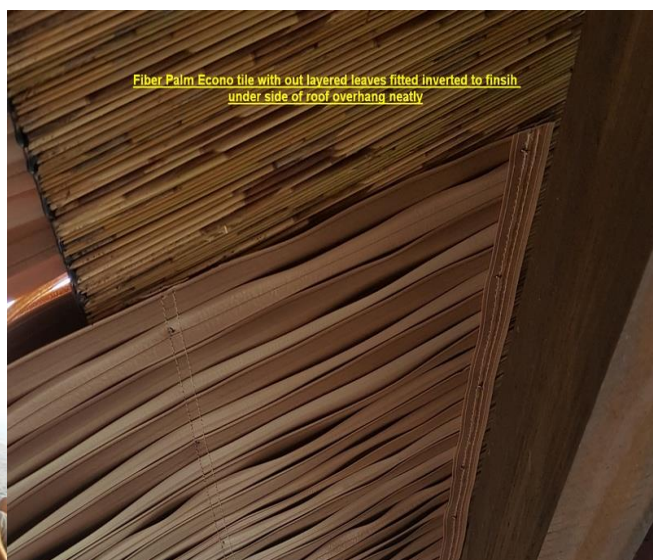



Contact & Postal Info:

Tel: +27 11 903 9204
Fax: +27 12 212 2341
Web: www.fiberroofing.com
E-mail: info@fiberroofing.com
P.O.Box 639, Alberton, 1450

FACTORY ADDRESS: INDUSTRIAL SITE - R59, KLIPRIVER, 1871 ,GAUTENG, SOUTH AFRICA

The finished products closely resemble a natural palm roof installation but provide the peace of mind synonymous with Fiber Roofing quality and durability.

